

# Plat of Survey

of

## The Westerly 1/2 of Lot 1 and the Westerly 8 feet of the Easterly 1/2 of Lot 1 of The White Subdivision,

located in Government Lot 3 in the Southwest 1/4 of Section 17, Town 4 North, Range 18 East, Town of East Troy, Walworth County, Wisconsin.

Surveyed for: **Mike Norton**  
W2060 Kings Lane  
East Troy, Wisconsin. 53120



Bearings referenced to the West line of the Southwest 1/4 of Section 17-4-18, recorded as N0°22'39"E in the Wisconsin State Plane Coordinate System, South Zone, (NAD-27).

Coordinates are referenced to the Wisconsin State Plane Coordinate System, South Zone, (NAD-27).

Lake

Beulah

Lot 1

Tax Parcel  
PWH 00001

0.348 Acre  
15,164 Sq.Ft.

House  
W2060

House

Proposed Garage

Kings Lane

Town of East Troy  
Village of East Troy

Outlot 2  
Lake Bluff

Copyright © 2019 by Olson Land Surveying, LLC.

All rights reserved. No part of this survey plat may be reproduced or transmitted in any form by any means - graphic, electronic, or mechanical, including photocopying, tracing, or information storage and retrieval systems - without permission in writing from Douglas G. Olson, Olson Land Surveying, LLC.

I hereby certify that I have surveyed the above described property in compliance with Chapter A-E 7 of the Wisconsin Administrative Code and that the map hereon is correct to the best of my professional knowledge and belief and shows the size and location of the property, its exterior boundaries, the location and dimensions of all visible structures thereon, boundary fences, apparent easements and roadways and visible encroachments, if any.

This survey is made for the exclusive use of the present owners of the property, and also those who purchase, mortgage or guarantee title thereto, within one year from the date hereof.

Douglas G. Olson  
Wisconsin Professional Land Surveyor - 2093

Note:

This Plat of Survey is a retracement of a Plat of Survey prepared by Lloyd L. Jensen dated December 8, 1975 which was a retracement of a Plat of Survey prepared by William Child dated September 22, 1926 which was a retracement of the plat of The White Subdivision dated May 14, 1919.

Notes:

- 1) This Plat of Survey is not certified unless signed and sealed in red ink.
- 2) This survey is subject to Wisconsin lien laws. This Plat of Survey is the notice of intent to file lien. Lien waiver required.
- 3) The Survey Date shown on this Plat of Survey is the completion date of the field work.

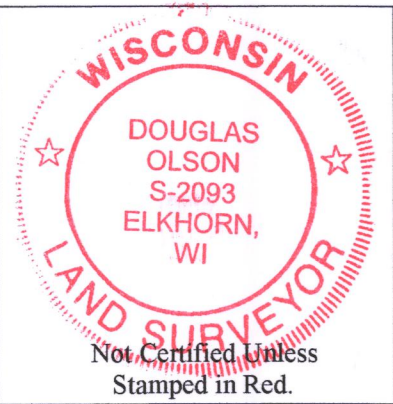
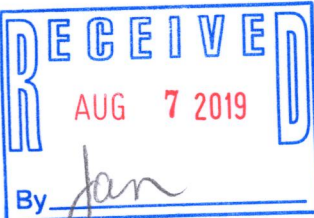

Survey Date: July 12, 2019.  
Revisions: No. 1 - Adjusted size & adjusted garage

Scale in Feet  
1" = 20'  
0' 10' 20' 40' 60'

45 South Wisconsin Street | P.O. Box 322  
Elkhorn, Wisconsin, 53121  
Telephone: (262) 723-8644  
Facsimile: (262) 723-8644  
Email: doug@olsonsurveying.com  
Website: www.olsonsurveying.com

**OLSON**  
LAND SURVEYING, LLC  
Rural | Residential | Commercial

Legend of Symbols & Abbreviations  
Found County Section Corner  
Found Iron Rod  
Found Mag Nail  
Set Iron Pipe, 1" dia.  
Recorded Information  
Concrete Cover  
Asphalt Surface  
Concrete Surface

Sheet 1 of 1 Sheets  
Drawing Name:  
Job Reference Number  
2019.068

2019.068

PWH-1 418-2655